

611  
1530  
314

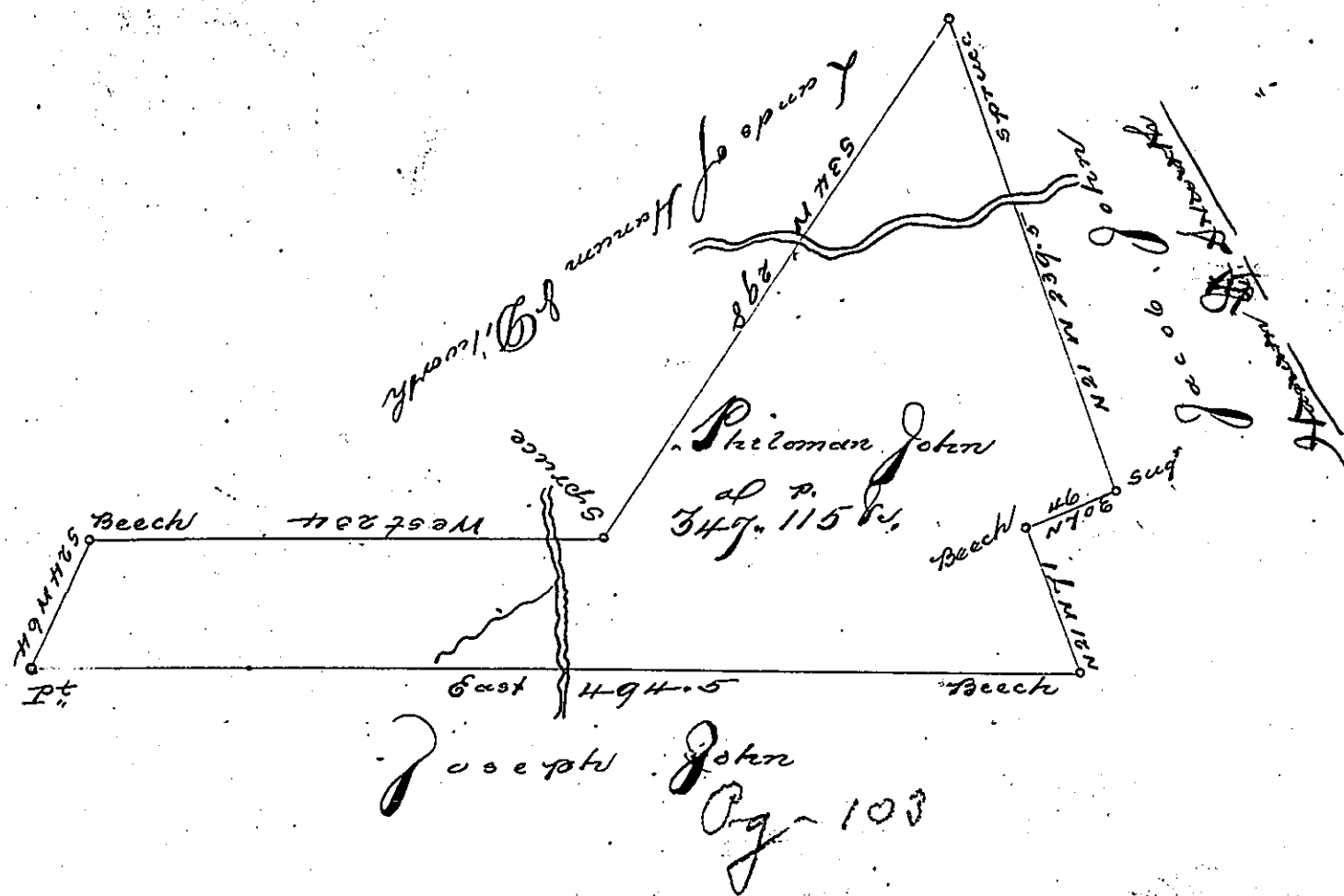

Situate on the head Waters of Conemough formerly Bedford, next  
 Somerset now Columbia County & Summerhill Township, Containing  
 347.115 and allowed of 69.0 first surveyed in 1794. on a warrant  
 granted to Philoman John dated March 12th 1794. and Resurveyed and  
 examined by me the 31 day of September 1830.

Wm. O'Keefe, Jr.

Jacob Sprangler Esq  
 Surveyor General

IN TESTIMONY that the above is a copy of the original remaining on file in  
 the Department of Internal Affairs of Pennsylvania, made  
 conformably to an Act of Assembly approved the 16th day of  
 February, 1833, I have hereunto set my Hand and caused  
 the Seal of said Department to be affixed at Harrisburg,  
 this 5th day of September 1899.

James Latta  
 Secretary of Internal Affairs.

